

Bilag D - Eftervisning af lejlighedsdisponering

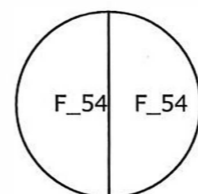

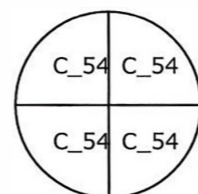
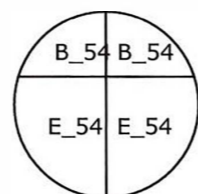
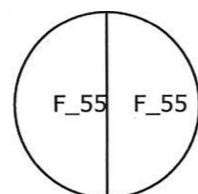
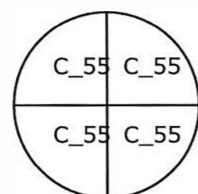
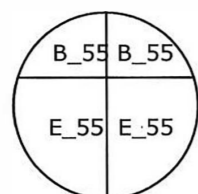
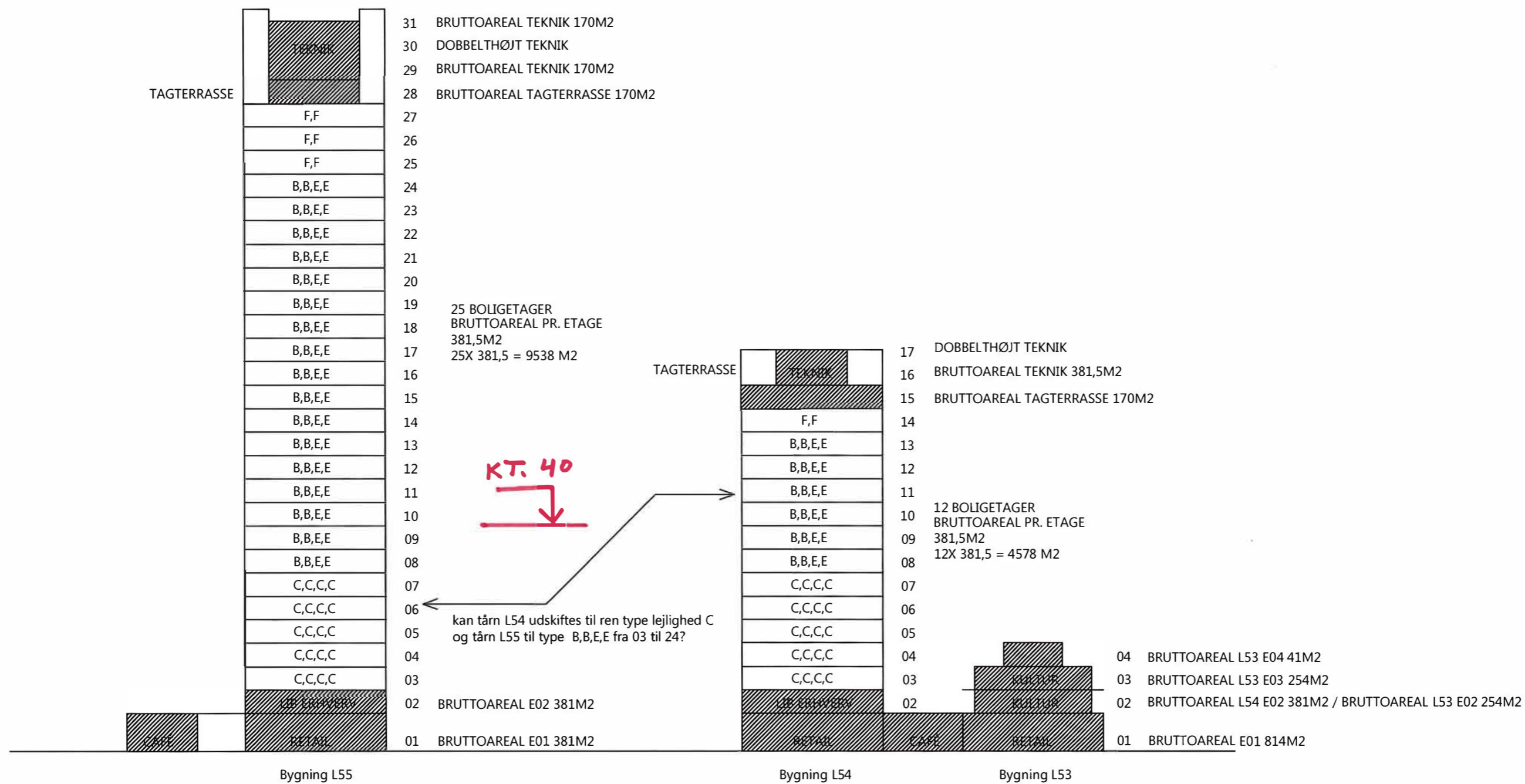
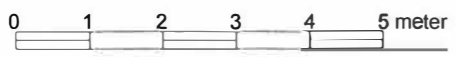
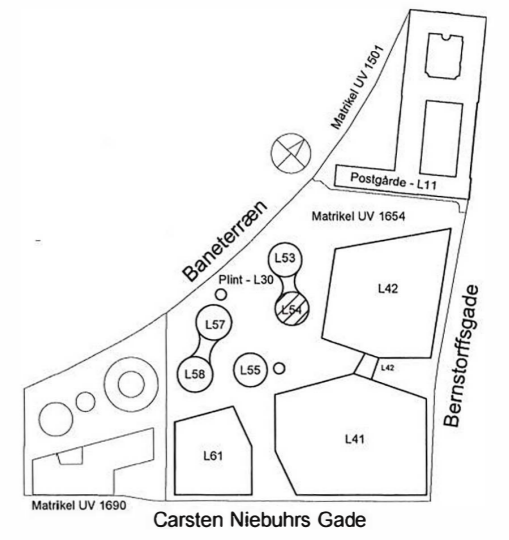
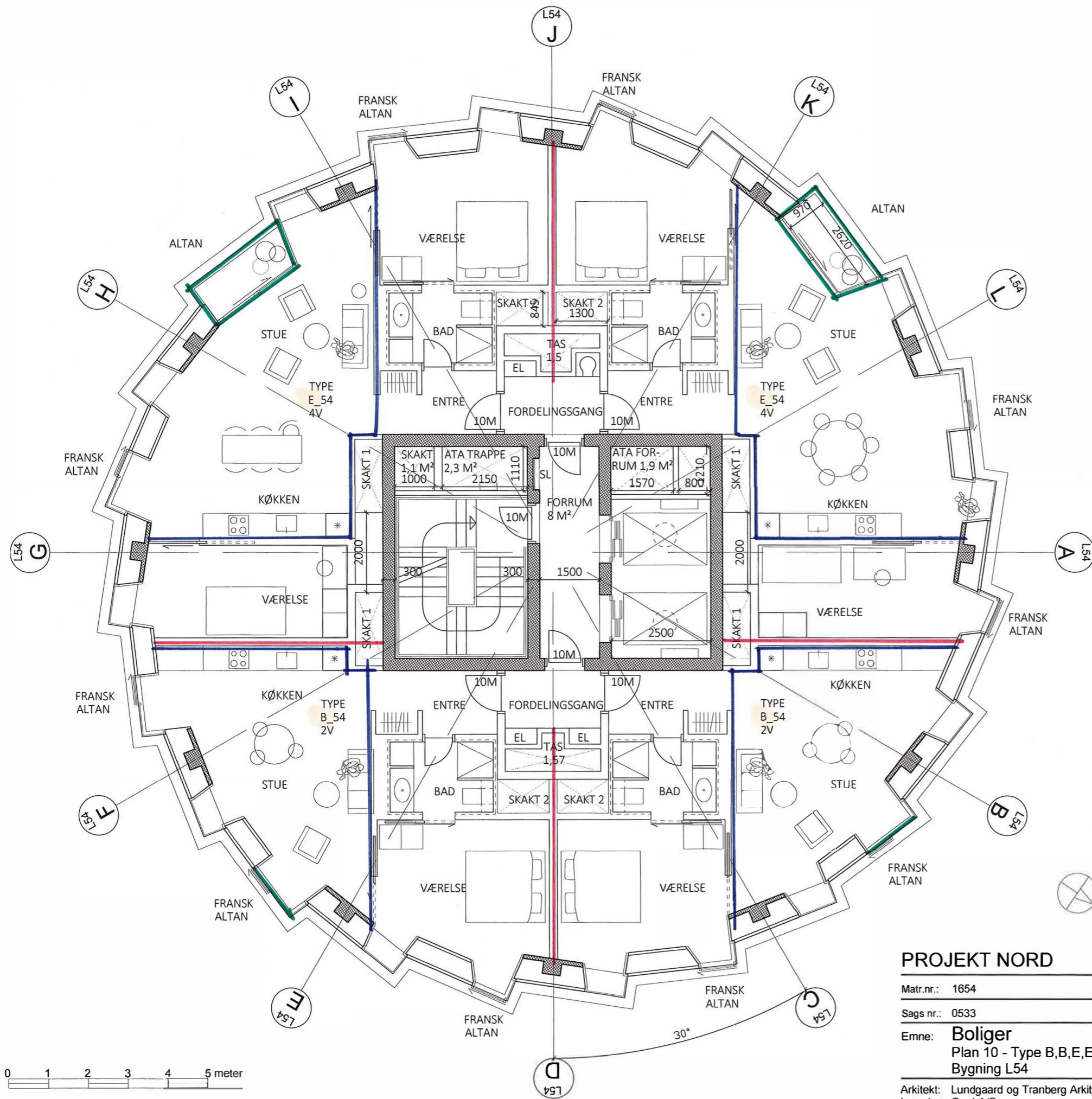

PROJEKT NORD

POSTEN

Matr.nr.: 1654	Projektfase: Dispositionsforslag	Dato: 2017.04.12
Sags nr.: 0533	Ansvar: ERF Godkendt: MKM Skala: 1:100	Revisionsdato: -
Emne: Boliger		Tegn.nr.: Rev
Plan 10 - Type B,B,E,E		
Bygning L54		

L54_K01_B02.003_H01_E10

Arkitekt: Lundgaard og Tranberg Arkitekter A/S Pilestræde 10, 3.sal, 1112 København K www.ltakitekter.dk tlf.:+45 3391 0717
 Ingeniør: Cowi A/S Parallelvej 2, 2800 Kongens Lyngby www.cowi.dk tlf.:+45 5640 0000

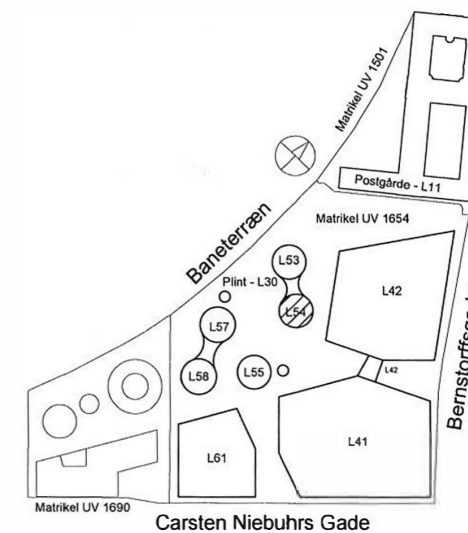
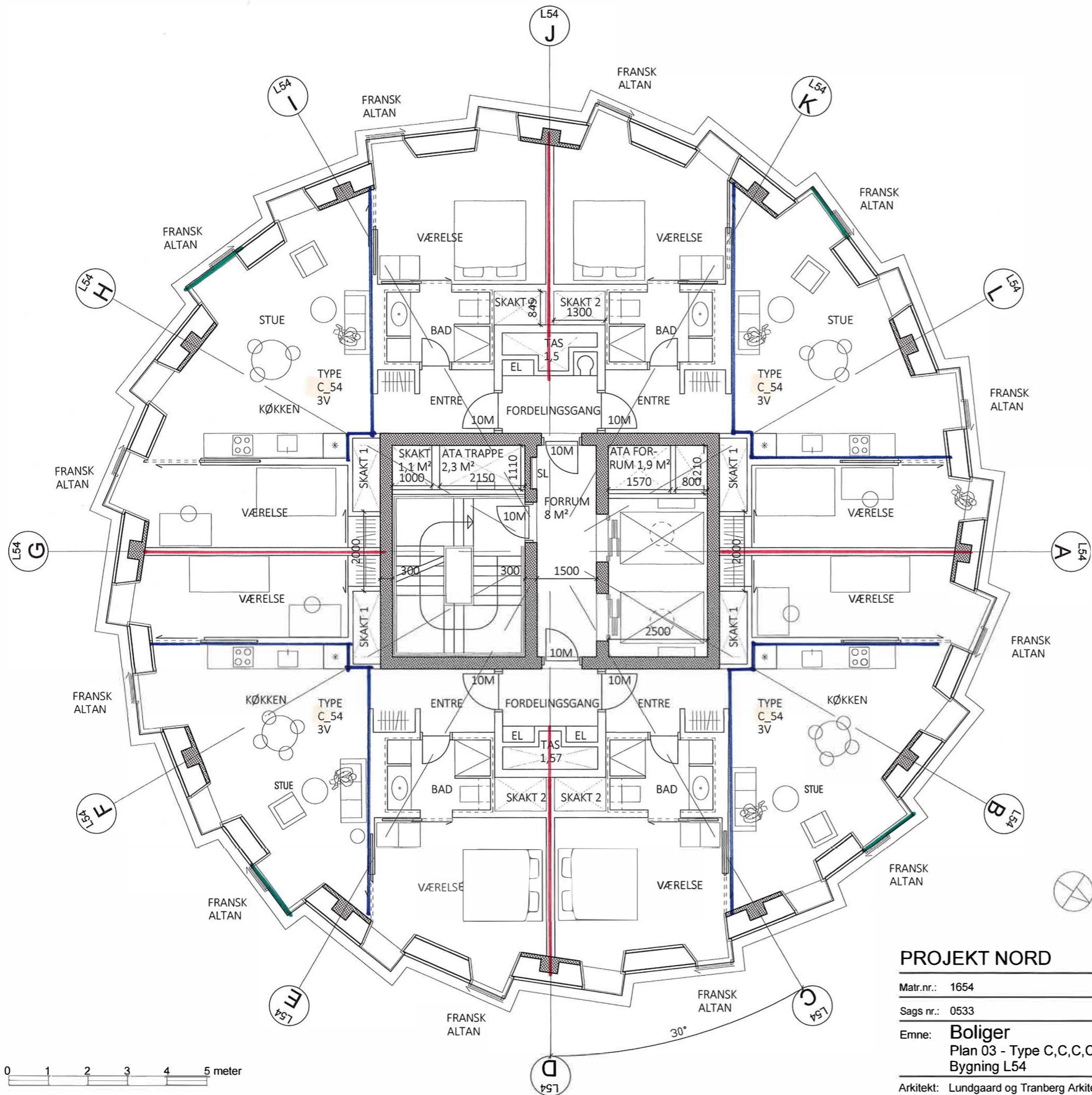

PROJEKT NORD

Matr.nr.: 1654

Projektfase: Dispositionsforslag

Dato: 2017.04.121

Sags nr.: 0533

Ansvar: ERF Godkendt: MKM

Skala: 1:100

Revisionsdato: -

Emne: **Boliger**
Plan 03 - Type C,C,C,C
Bygning L54

Tegn.nr.: Rev

L54_K01_B02.003_H01_E03

Arkitekt: Lundgaard og Tranberg Arkitekter A/S
Ingeniør: Cowi A/S

Pilestræde 10, 3.sal, 1112 København K
Parallelvej 2, 2800 Kongens Lyngby

www.ltakitekter.dk tlf.: +45 3391 0717
www.cowi.dk tlf.: +45 5640 0000

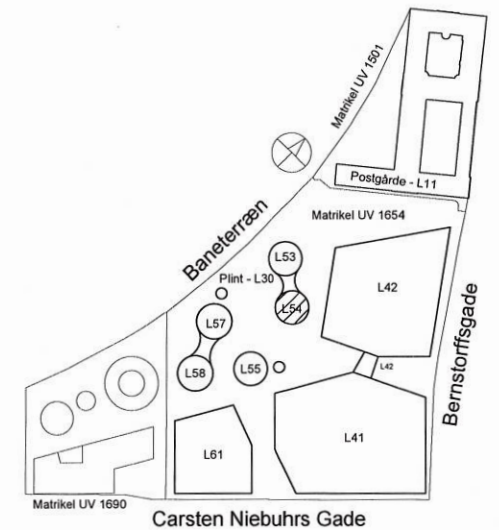
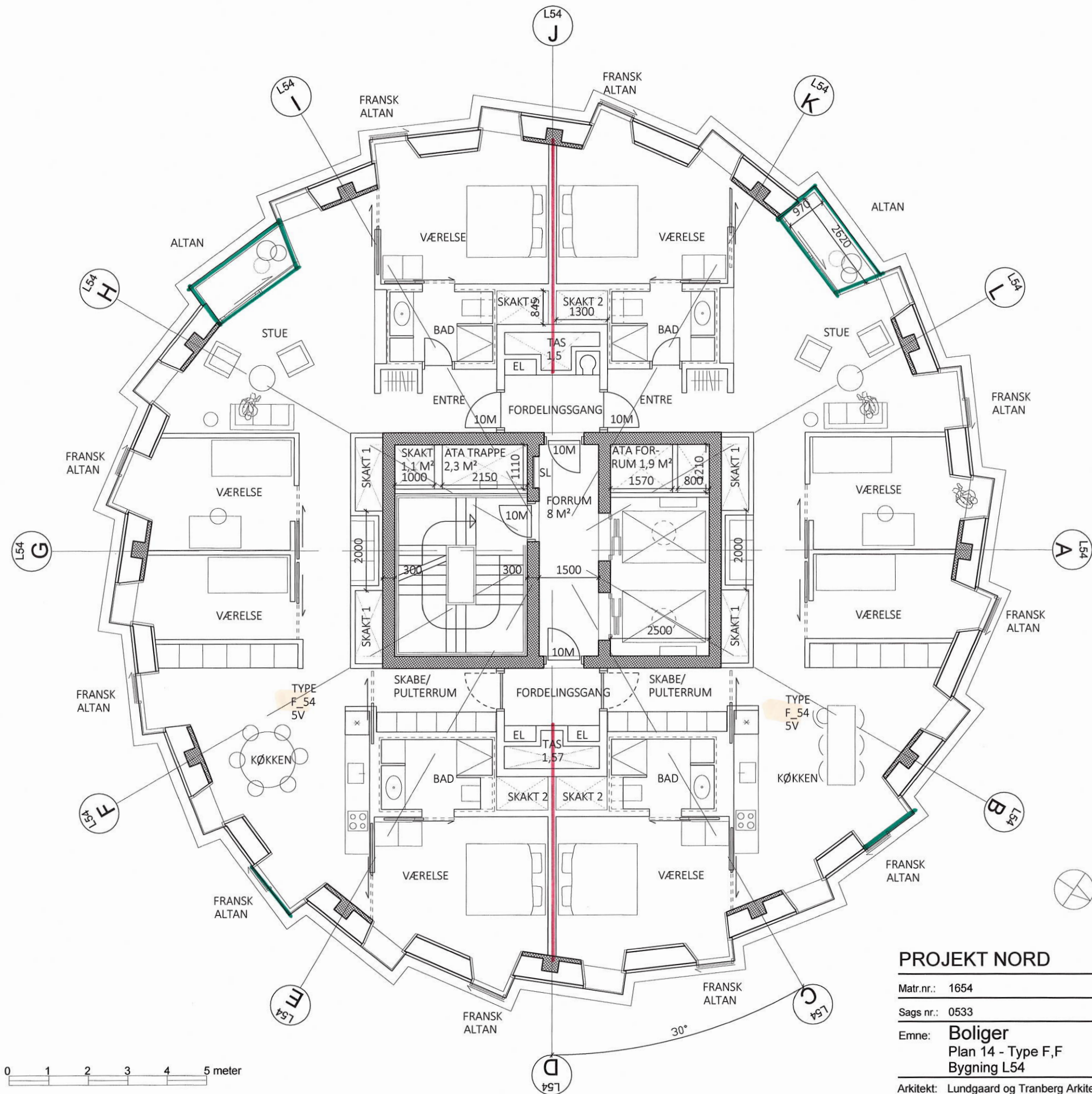

PROJEKT NORD

Matr.nr.: 1654

Projektfase: Dispositionsforslag

Dato: 2017.04.12

Sags nr.: 0533

Ansvar: ERF Godkendt.: MKM Skala: 1:100

Revisionsdato: -

Emne: **Boliger**
Plan 14 - Type F,F
Bygning L54

Tegn.nr.: Rev

L54_K01_B02.003_H01_E14

Arkitekt: Lundgaard og Tranberg Arkitekter A/S
Ingeniør: Cowi A/S

Pilestræde 10, 3.sal, 1112 København K
Parallelvej 2, 2800 Kongens Lyngby - DK

www.ltarkitekter.dk tlf.: +45 3391 0717
www.cowi.dk tlf.: +45 5640 0000